

# PRODUCT DATASHEET

## DP 1500 30 W 4000K IP65 GY

LEDVANCE DAMP PROOF LED | LED damp-proof luminaires

---

### Areas of application

- Industrial and storage facilities
- Car parks and underpasses
- Garages
- Workshops, assembly lines



---

### Product benefits

- Evenly distributed light
- Energy savings of up to 50 % (compared to luminaires that use fluorescent lamps)
- Easy installation, no tools required for connection
- 5 years guarantee

---

### Product features

- High luminous efficacy: up to 115 lm/W
- Beam angle: 105°



---

**TECHNICAL DATA****Electrical data**

Nominal wattage	30.00 W
Nominal voltage	220...240 V
Mains frequency	50/60 Hz
Nominal current	150 mA
Inrush current	6 A
Inrush current time $T_{h50}$	270 $\mu$ s
Max. no. of lum. on circuit break. B16 A	43
Max. no. of lum. on circuit break. C10 A	41
Max. no. of lum. on circuit break. C16 A	66
Power factor $\lambda$	> 0.90
Total harmonic distortion	< 20 %
Protection class	I
Operating mode	Integrated LED driver

**Photometrical data**

Luminous flux	3500 lm
Luminous efficacy	115 lm/W
Color temperature	4000 K
Light color (designation)	Cool White
Color rendering index Ra	> 80
Standard deviation of color matching	$\leq 5$ sdc <sub>m</sub>
Photobiological safety group acc. to EN62778	RG0
Beam angle	105 °

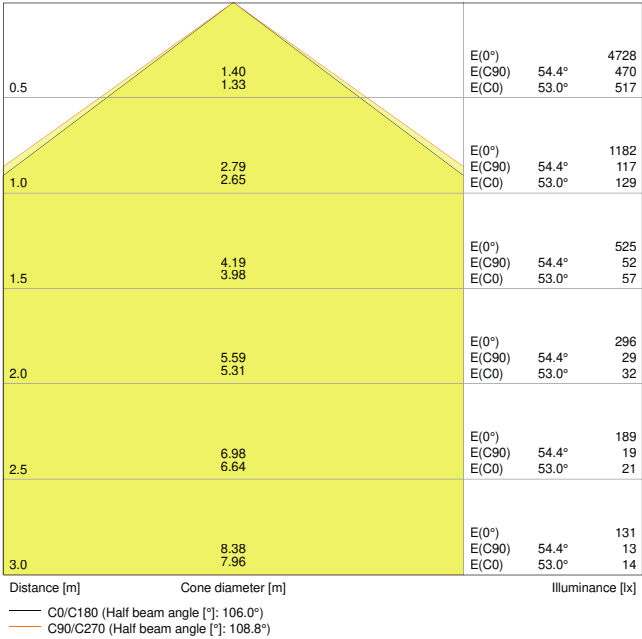

LDC typ cone

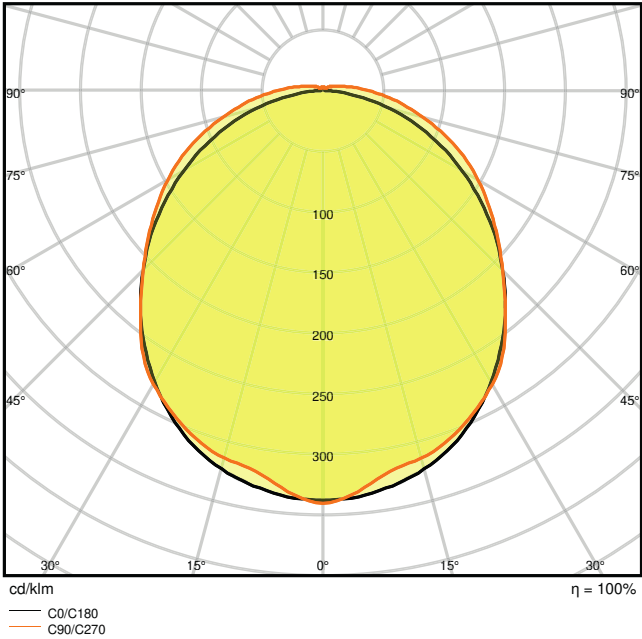

LDC typ polar

Dimensions & Weight

Length	1500.00 mm
Width	95.00 mm
Height	78.00 mm
Product weight	2300.00 g

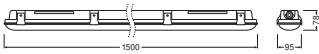

Materials & Colors

Product color	Gray
Housing color	Gray
Body material	Polycarbonate (PC)
Cover material	Polycarbonate (PC)
Light emitting surface material	Polycarbonate (PC)

Glow Wire Test according to IEC 60695-2-12	850 °C
--------------------------------------------	--------

### Application & Mounting

Ambient temperature range	-30...+40 °C
Type of connection	Screwless terminal, 3-Pole
Type of protection	IP65
Protection class IK (shock resistance)	IK08
Dimmable	No
Mounting type	Suspended/Surface
Mounting location	Ceiling / Wall
Application environment	Indoor
LED module replaceable	Not replaceable

### Lifespan

Lifespan L70/B50 at 25 °C	50000 h
Lifespan L80/B10 at 25 °C	35000 h
Lifespan L90/B10 at 25 °C	20000 h
Number of switching cycles	25000

### Control gear

Output current	350 mA
----------------	--------

### Certificates & Standards

Standards	CE / CB / TÜV SÜD / EAC / RoHS
Luminaire with limited surface temperature, "D sign"	Yes
Ball shot safe	No

### EQUIPMENT / ACCESSORIES

- Stainless steel clamps with safety screws included
- Mounting accessories included (suspension kit, theft protection kit)

### DOWNLOAD DATA

DOWNLOAD DATA	
	User instruction

## DOWNLOAD DATA



Tender documents



Certificates



Certificates



On-Pack-Info



On-Pack-Info



IES file (IES)



LDT file (Eulumdat)



M3D file (3D Model)



ULD file (DIALux)



UGR file (UGR table)

## LOGISTICAL DATA

Product code	Packaging unit (Pieces/Unit)	Dimensions (length x width x height)	Gross weight	Volume
4058075079939	Folding box 1	1,505 mm x 102 mm x 84 mm	2528.00 g	12.89 dm <sup>3</sup>
4058075079946	Shipping box 6	1,525 mm x 333 mm x 192 mm	16355.00 g	97.50 dm <sup>3</sup>

The mentioned product code describes the smallest quantity unit which can be ordered. One shipping unit can contain one or more single products. When placing an order, for the quantity please enter single or multiples of a shipping unit.

## ADDITIONAL CATALOG INFORMATION

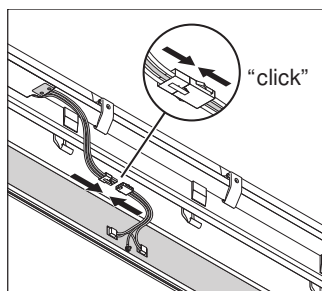
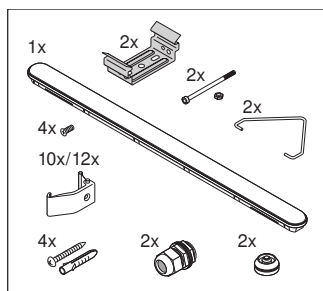

---

## References / Links

– For Guarantee see [www.ledvance.com/guarantee](http://www.ledvance.com/guarantee)

---

## DISCLAIMER

Subject to change without notice. Errors and omission excepted. Always make sure to use the most recent release.